

permobil | SEATING + POSITIONING

ROHO® AGILITY® Custom Back Support Cushion Supplement

Supplier: These instructions must be given to the user of this product.

Operator (Individual or Caregiver): Before using this product, read instructions and save for future reference.



This document is provided as a supplement to the product information provided with your ROHO AGILITY Back System and Hardware.

The ROHO® AGILITY® Custom Back Support Cushion (AGILITY Custom Back Cushion) is a custom-made device designed to meet an individual's specific needs. The prescribing clinician should be contacted for questions regarding the full intended use of this custom product.

Product Specifications

Materials: neoprene rubber, made without latex; Zytel valve; polyethylene foam

Information for Safety



Caution: Prolonged exposure to ozone may degrade materials used in this product, affect its performance, and void the product warranty.

DRY FLOATATION® Air Insert: Adjustment Instructions

1. Place the AGILITY Custom Back Cushion on the AGILITY Back Shell, air cells facing the individual. Use the hook and loop fastener strips to secure the back cushion to the back shell.
2. Open the valve. Slide the rubber nozzle of the hand pump over the valve. Inflate until the air insert begins to arch slightly. Pinch the rubber nozzle of the hand pump and close the valve. Remove the hand pump. *(Repeat this process for each valved section until the entire air insert is inflated.)*
3. The individual should sit in their usual seated position. Make sure the back cushion is correctly placed behind the individual.
4. Adjust the inflation of the air insert as necessary. Make sure that there is at least ½ in. (1.5 cm) of air supporting the individual's bony prominences.
5. Make sure all valves are closed after adjustment is complete.

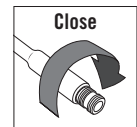
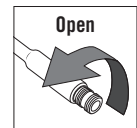

Warning: Check inflation! Make sure that there is at least ½ in. (1.5 cm) of air supporting the individual's bony prominences. Follow the prescriber's recommended inflation levels.

Storage, Disposal and Recycling

Storage: Clean and disinfect the product before storing. Open the inflation valve(s). Deflate the product (detach any product sections). Store the product in a container that protects the product from moisture, contaminants and damage.

Disposal: The components of the products in this manual are associated with no known environmental hazards when properly used and when disposed of in accordance with all local/regional regulations. Incineration must be performed by a qualified, licensed waste management facility.

Recycling: Contact a local recycling agency to determine recycling options for the product. For more recycling information, contact Customer Support.

DRY FLOATATION Air Insert: Cleaning and Disinfecting

Warnings:

- Inflation valve(s) **MUST** be closed to make sure that water does not enter the product during cleaning or disinfecting.
- Follow all manufacturer bleach container and germicidal disinfectant safety guidelines.
- Note about sterilization: High temperatures accelerate aging and will damage the product assembly. The products featured in this manual are not packaged in a sterile condition, nor are they intended or required to be sterilized prior to use. If institution protocol demands sterilization: First, follow the cleaning and disinfecting instructions; then, open the inflation valve and use the lowest possible sterilizing temperature, but not to exceed 70°C (158°F), for the shortest time possible. **DO NOT** autoclave.

 **Cautions:** DO NOT machine wash or machine dry the air insert. Use of the following may cause damage to the cushion: abrasives (steel wool, scouring pads); caustic, automatic dishwasher detergents; cleaning products that contain petroleum or organic solvents, including acetone, toluene, Methyl Ethyl Ketone (MEK), naphtha, dry cleaning fluid, adhesive remover; oil-based lotions, lanolin, or phenolic-based disinfectants; ozone gas; ultraviolet light cleaning methods.

To Clean the Air Insert: Remove the air insert from the cover and foam pad, close valve(s) and place in a large sink. Hand wash, using a mild, liquid hand soap, hand dishwashing liquid, laundry detergent, or other multipurpose detergent (Follow product label instructions.) Gently scrub all air insert surfaces, using a soft plastic bristle brush, a sponge or a cloth. Rinse thoroughly with clean water. Air dry. **DO NOT** expose to direct sunlight.



 **Caution:** Rinse thoroughly. Detergent residue may cause air cells to stick together.

To Disinfect the Air Insert: Repeat the cleaning instructions, using 1 part household liquid bleach per 9 parts water. Keep the product wet with the bleach solution for 10 minutes. Rinse thoroughly with clean water. Air dry.



Limited Warranty

Limited Warranty Term, from the date the product was originally purchased: DRY FLOATATION Air Insert: 36 months; Cover and Foam Pad: 18 months. See also the Limited Warranty supplement provided with your product, or contact Customer Support.

Contact Information



ROHO, Inc.

Administrative Offices: 100 North Florida Avenue, Belleville, IL 62221-5429, U.S.A.

Mailing/Shipping Address: 1501 South 74th Street, Belleville, IL 62223-5900, U.S.A.

U.S.A.: 800-851-3449 • Fax: 888-551-3449 • Customer Support: orders.roho@permobil.com

Outside the U.S.A.: 618-277-9150 • Fax: 618-277-6518 • intlorders.roho@permobil.com

permobilus.com

Products may be covered by one or more U.S. and foreign patents and trademarks, including AGILITY® DRY FLOATATION and ROHO®.

Product information is changed as needed; current product information is available at permobilus.com.

ROHO, Inc. is part of Permobil Seating and Positioning.

Rev. 2018-10-19

© 2013, 2018 Permobil



MDSS GmbH
Schiffgraben 41
30175 Hannover, Germany

